

APPENDIX 1 – Location and Site Plans

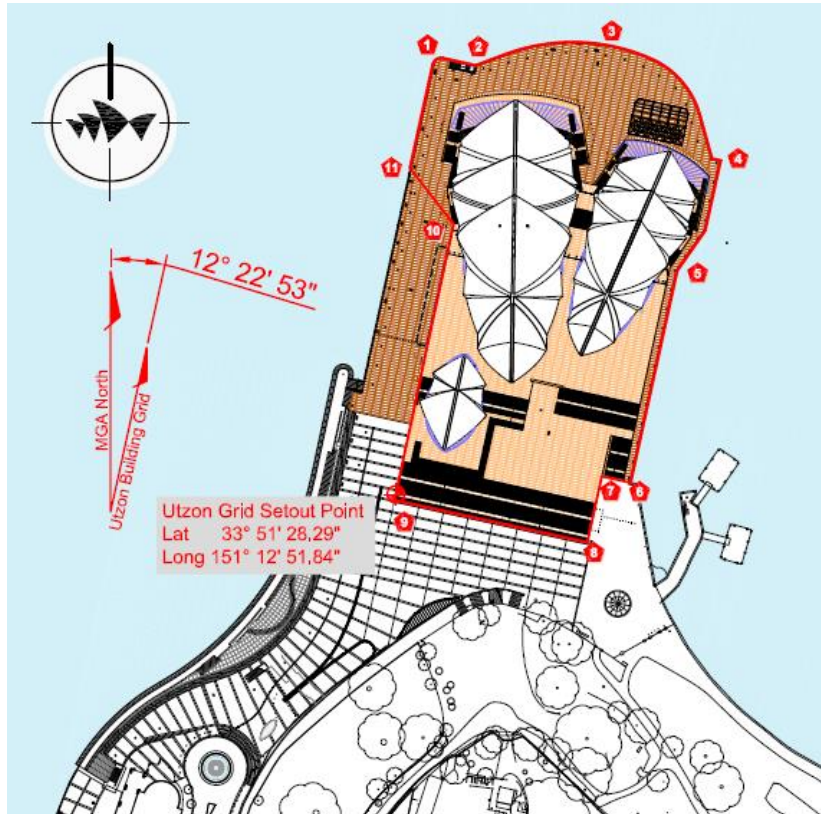

EPBC Referral

Sydney Opera House Building Renewal Program – Concert Hall, Under the Steps, Creative Learning Centre and Southern Foyers Works

Date of Referral: April 2017

Location

Circular Quay and Macquarie Street, Bennelong Point, Sydney, comprising:

- Lot 5 in Deposited Plan 775888 at Bennelong Point, Parish of St. James, county of Cumberland, city of Sydney; and
- Lot 4 in Deposited Plan 787933 at Circular Quay East, Parish of St. James, county of Cumberland, city of Sydney.

Project Works Area

Approx. 2.28ha.

Bounding Location Coordinate Points			Bounding Location Coordinate Points		
Point ID	Latitude	Longitude	Point ID	Latitude	Longitude
1	33° 51' 22.17"	151° 12' 52.67"	7	33° 51' 28.13"	151° 12' 55.31"
2	33° 51' 22.41"	151° 12' 53.26"	8	33° 51' 29.09"	151° 12' 55.06"
3	33° 51' 22.06"	151° 12' 54.37"	9	33° 51' 28.43"	151° 12' 51.80"
4	33° 51' 23.70"	151° 12' 57.42"	10	33° 51' 24.55"	151° 12' 52.85"
5	33° 51' 24.99"	151° 12' 56.89"	11	33° 51' 23.98"	151° 12' 52.07"
6	33° 51' 28.24"	151° 12' 55.79"			



Sydney Opera House – Location Map (source: SIX Maps)

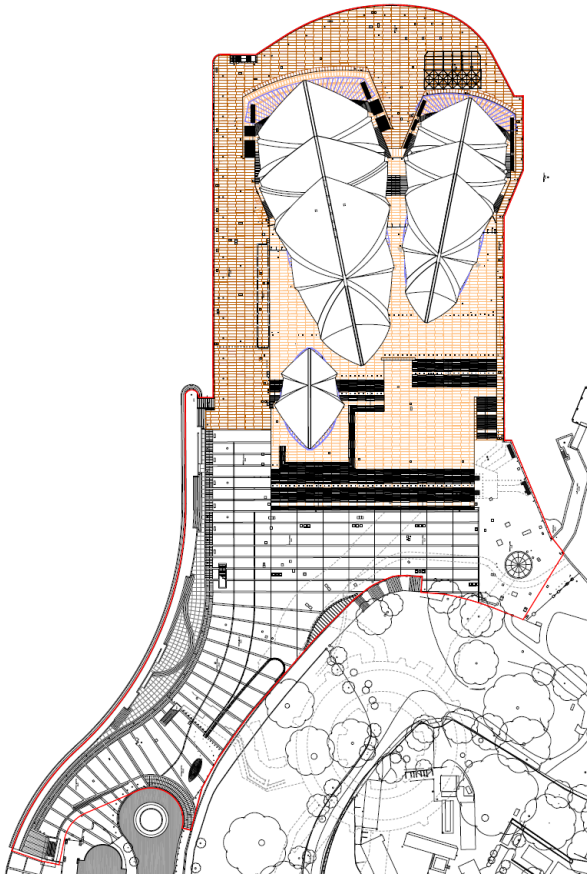

Sydney Opera House – Site Plan (source: Sydney Opera House Trust)